

Welcome to a Good Night's Sleep!



Telemed Setup Appointment Guide

**You are scheduled for a TeleMed CPAP/Bi-Level Setup.
Here are best practices to follow to prepare for your appointment:**

- ▶ Use speakerphone or headphones to allow your hands to be free during instruction.
- ▶ Access your email to receive communications and documents.
- ▶ Fill your humidifier with distilled water (available at most pharmacies).
- ▶ Have a mirror nearby to assist while fitting your mask.
- ▶ Allow sufficient table top space to fit your machine and mask.
- ▶ Unpack the contents in the box and plug in your machine prior to your appointment.
- ▶ If you have a Zoom appointment, please test your audio and settings on your device in advance using this link: <https://zoom.us/test>.

What's in the box?

1. Contents:

- ▶ “We’re here to support your journey to better sleep” flyer
- ▶ Patient Hub App flyer

To guide you through your appointment, refer to the **Sleep Therapy Training & Education Checklist** in the **CPAP Appointment Reminder email** you received the business day prior to your scheduled appointment.

For information relating to the services & equipment provided to you by MSC Sleep, please visit the Patient Resource Center at: <https://www.medicalserviceco.com/patient-resource-center>

2. CPAP/Bi-Level Carry Bag Contents

3. Mask with Fitting Instructions

CPAP Tubing
(inside the zipper)

Device User Guide,
RMDpulse App Brochure
& AirMini Brochure

PAP Device
& Humidifier
Chamber



Power Cord

CPAP Mask

Quick Start Guide

Please complete these instructions to set up your machine prior to your scheduled appointment.



1 Place the device on a stable level surface.



4 Open the water tub and fill it with distilled water under room temperature up to the maximum water level mark. The humidifier tub must be removed from the device before adding water.



2 Connect the power cord into the power inlet at the rear of the device. Connect one end of the power cord into the AC adaptor and the other end into the power outlet.

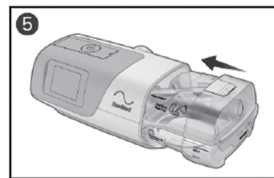

5 Close the water tub and insert it into the side of the device.

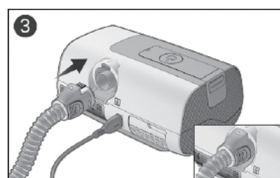

3 Connect the air tubing firmly to the air outlet located on the rear of the device.

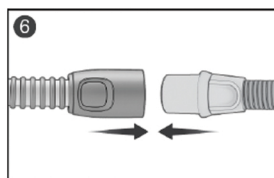

6 Connect the free end of the air tubing firmly onto the assembled mask. Press Start/Stop to begin therapy.